

INCLUDED

- Two 10W wireless wall chargers
- USB charging cable
- Instruction manual

COMPONENT IDENTIFICATION

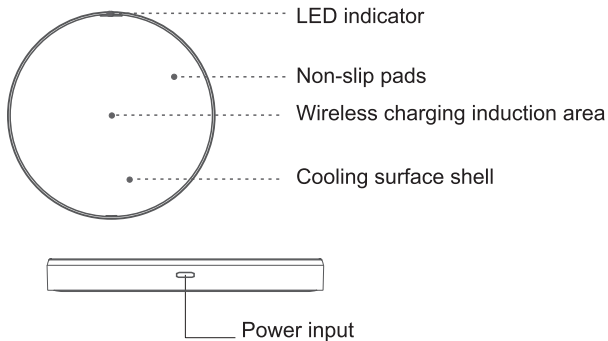

INSTRUCTIONS

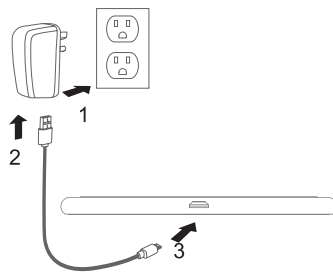

1. Use the included USB charging cable and wall power adapter (not included) to plug in the charging pad.
2. Centre your Qi-enabled device on the wireless charging area.
3. A white LED light will flash for 14 seconds and turn OFF to indicate the wireless charger is ON. A green LED light will turn ON for 20 seconds, and then turn OFF to indicate the device is charging. If the device is fully charged, the LED lights will remain OFF.

NOTE: The wireless quick charging will only function with a wall adapter that supports Quick Charge 2.0/3.0 (not included).

SPECIFICATIONS

Input	DC 5V/2A; DC 9V/1.67A
Wireless Charging Distance	≤6mm
Wireless Charging Efficiency	≥70%
Dimensions	99 x 6.5 mm

WARNINGS

- Handle with care
- Use only in a dry, well-ventilated area with a temperature of 0°C to 45°C
- Keep away from extreme heat, direct sunlight, humidity and moisture
- **DO NOT** place near a magnetic or chip card (ID card, bank card, etc.)
- Keep 20cm between the charger and implantable medical devices (cardiac pacemakers, cochlear implants, etc.)
- Keep away from children
- Disconnect from power before cleaning
- **DO NOT** use if wet or damaged
- **DO NOT** open, modify or repair
- **DO NOT** use with wet hands
- Use only as described in this manual

CAN RSS-216 / CNR-216 IC:22348-8080

This device contains licence-exempt transmitter(s)/receiver(s) that comply with Innovation, Science and Economic Development Canada's licence-exempt RSS(s). Operation is subject to the following two conditions: (1) This device may not cause interference. (2) This device must accept any interference, including interference that may cause undesired operation of the device.

RF EXPOSURE INFORMATION

This equipment complies with IC RSS-102 radiation exposure limits set forth for an uncontrolled environment. This equipment should be installed and operated with minimum distance 20cm between the radiator and your body.

THE SOURCE - WARRANTY

The Source warrants that this product will be free from defects in materials and workmanship for a period of twelve (12) months from the date of purchase. Within this period, simply take the product and your proof of purchase to any The Source store or participating dealer and the product will be replaced (where available) without charge. Any product which has been subject to misuse or accidental damage is excluded from this warranty.

This warranty is only applicable to a product purchased through The Source company-owned stores or participating dealers in Canada where the warranty is included with the product. While this warranty does not confer any legal rights other than those set out above, you may have additional statutory rights which will vary under the laws of the various countries, states, provinces and other governmental entities in which The Source operates. This warranty is subject to all statutory rights you may have in Canada.

Imported by:
The Source, Barrie, Ontario, Canada, L4M 4W5
Manufactured in China
www.thesource.ca
© 2019 The Source. All rights reserved.

