

WIRELESS SPEAKER WITH BIKE MOUNT

HRSP 5003
COAST

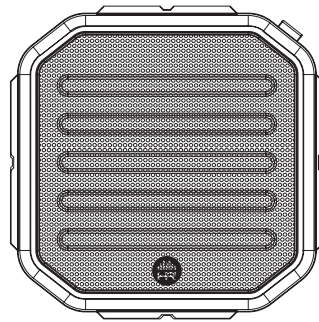

The Bluetooth® word mark and logos are registered trademarks owned by Bluetooth® SIG, Inc. and any use of such marks by The Source (Bell) Electronics Inc. is under license. Other trademarks and trade names are those of their respective owners.



WHAT'S INCLUDED:

- Speaker
- Micro USB charging cable
- 3.5mm to 3.5mm audio cable
- Bike mount
- Lanyard
- Reset pin
- Instruction Manual

COMPONENT IDENTIFICATION

1. Call
2. Power ON/OFF
3. Increase volume/Next track +
4. Decrease volume/Previous track -
5. LED indicator
6. USB charging port
7. AUX in
8. Reset
9. NFC connection location
10. Bike mount screw
11. Bike mount

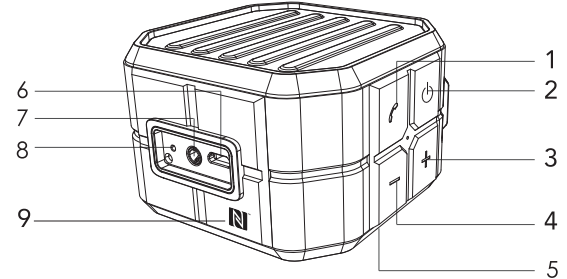
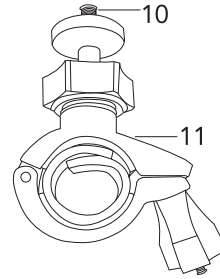

PRODUCT OVERVIEW

You can use this item with iPad®, iPhone®, iPod® devices and many types of smartphones to stream music, and enjoy handsfree calling. In order to get the best results when using this device, please read this manual first before using. This unit has IPX6 rating: Protected against heavy seas – Water projected at all angles through a 12.5mm nozzle at a flow rate of 100 litres/min at a pressure of 100kN/m² for 3 minutes from a distance of 3 metres/10 feet.

Do not submerge in water.

PAIRING

1. Make sure your Bluetooth® audio source is held within 10 metres of your speaker.
2. Turn the speaker ON by pressing the Power ON/OFF button. The LED will flash blue and red alternately, the speaker will beep once in pairing mode.
3. Enable your Bluetooth® device, and make sure it is in searching mode.
4. Select "HR Coast" from the list of discovered Bluetooth® devices on your mobile phone. Once paired you will hear a short beep and the blue LED remain ON.
5. You can now listen to your music or make/receive telephone calls on the speaker.
6. To turn the speaker OFF hold the Power ON/OFF button, you will hear a beep.
7. When streaming music if the Power ON/OFF button is short pressed the speaker will go into pairing mode. Current connected device will disconnect.

Tip: The next time you switch the speaker ON, it will connect automatically as long as your Bluetooth® function is switched ON on your audio device.

When you disconnect the speaker while paired, the blue and red LED will start to blink quickly, the speaker has entered into pairing mode. If there is no device paired within 15 minutes, the speaker will turn OFF.

PAIRING BY ONE-TOUCH CONNECTION WITH NFC

1. Enable the NFC function on your device.
2. Use your NFC-enabled device and touch the NFC logo on the speaker.
3. Confirm the NFC connection on your device. This will vary depending on your device, check your device manual for compatibility.
4. The speaker will beep.

CHARGING

This speaker has a built-in rechargeable Li-Ion battery. Fully charge the speaker before first use. Charge the battery as follows:

1. Connect one end of the included USB charging cable to the charging port on your speaker. Then plug the other end of the USB charging cable into a suitable port on your computer or 5V/1A power adapter (sold separately).
2. The red LED light will turn ON. When the charge is complete the red LED light will turn OFF.
3. It will take 4 hours to fully charge the speaker by PC USB port.

Tip: When battery is low the speaker will beep every 30 seconds and the LED indicator will flash red. Charge the speaker. If the speaker is not plugged in to charge within approximately 5 minutes, it will turn OFF.

OPERATION

1. To increase the volume long press the Increase volume/Next track + button.
2. To decrease the volume long press the Decrease volume/Previous track - button.
3. Short press the Increase volume/Next track + button to skip to the next track.
4. Short press the Decrease volume/Previous track - button to skip to the previous track.

HANDSFREE SPEAKERPHONE

When a smartphone is connected to your speaker follow the steps below to take calls handsfree.

1. When streaming music and there is an incoming call the music will stop and the speaker will ring.
2. Short press the call button to answer the call.
3. Short press the call button again to end the call.
4. Long press the call button to reject the call.

FACTORY RESET

To reset to the factory settings insert the reset pin into the reset hole. The speaker will turn OFF. Turn the speaker ON by pressing the Power ON/OFF button.

LINE-IN

1. Use the supplied 3.5mm cable to connect the speaker directly with your device.
 2. The LED turns solid blue and the speaker will beep. Bluetooth® connection will disconnect.
- Tip:** LINE-IN always takes priority. Make sure the 3.5mm audio cable is not connected during Bluetooth® use.

BIKE MOUNT INSTRUCTIONS

1. Remove nut from bracket. Position the bracket onto handlebar. Tighten nut, and adjust bracket in the desired position.
2. Position the speaker over the screw on the mount and tighten.
3. Check the speaker and bike mount to make sure both are fastened.

TO PLAY MUSIC FROM YOUR PC OR LAPTOP

After pairing the device to your PC or laptop, right-click on the speaker icon on the lower right hand corner of the task bar, select "Playback devices". Under the "Playback" tab, the paired device will show within the list. To connect it, click on the device to set it as the default device. The audio will start to play from the paired device.

UNDERSTANDING THE LED STATUS LIGHTS

- **When charging your speaker**
 - o Solid red LED=charging
 - o Red LED OFF=charging complete
- **When pairing your speaker to a Bluetooth® device**
 - o Quick blinking blue and red LED=Bluetooth® not connected, ready to pair
 - o Solid blue LED=Bluetooth® connected
- **When connected via LINE-IN**
 - o Solid blue LED=connected

TECHNICAL SPECIFICATIONS

Carrier Frequency : Bluetooth® 2.1+EDR
 Battery Capacity : 3.7V, 800mAh
 Frequency Response: 90Hz-20KHz
 Operation Distance: Up to 10 metres/33 feet
 Output Power: 5W (Max.)
 Impedance: 4 Ohms

NOTE: This speaker is in compliance with the specified Bluetooth® version. It does not guarantee compatibility with all the functions on every Bluetooth® enabled device. Please check your mobile phone's user manual for compatibility and functionality.

TROUBLESHOOTING

No Sound:

- Ensure the speaker is charged and has enough battery power for operation
- Ensure the speaker is switched ON
- Ensure Bluetooth® device is ON
- The volume of the speaker is too low, adjust the volume to an appropriate level

WARNING: Changes or modifications to this unit not expressly approved by the party responsible for compliance could void the user's authority to operate the equipment.

THE FCC WANTS YOU TO KNOW

This device complies with Part 15 of the FCC rules. Operation is subject to the following two conditions:

- (1) This device may not cause harmful interference and
- (2) this device must accept any interference received, including interference that might cause undesired operation.

Changes or modifications to this unit not expressly approved by the party responsible for compliance could void the user's authority to operate the equipment.

Industry Canada Notice

This device complies with RSS-247 of Industry Canada. Operation is subject to the following two conditions:

- (1) this device may not cause interference, and
- (2) this device must accept any interference, including interference that may cause undesired operation of the device.

This digital apparatus does not exceed the Class B limits for radio noise emissions from digital apparatus set out in the Radio Interference Regulations of Industry Canada.

IC NUMBERS: 255A-8074001

THE SOURCE - WARRANTY

The Source warrants that this product will be free from defects in materials and workmanship for a period of 12 months from the date of purchase. Within this period, simply take the product and your proof of purchase to any The Source store or participating dealer and the product will be replaced (where available) without charge. Any product which has been subject to misuse or accidental damage is excluded from this warranty.

This warranty is only applicable to a product purchased through The Source company-owned stores or participating dealers in Canada where the warranty is included with the product. While this warranty does not confer any legal rights other than those set out above, you may have additional statutory rights which will vary under the laws of the various countries, states, provinces and other governmental entities in which The Source operates. This warranty is subject to all statutory rights you may have in Canada.

Imported by:
 The Source,
 Barrie, Ontario, Canada, L4M 4W5
 Manufactured in China
www.headrushaudio.com

