

OWNER'S MANUAL —

Before using the product, please read the instructions thoroughly and retain them for future reference.

8063591



The Bluetooth® word mark and logos are registered trademarks owned by Bluetooth® SIG, Inc. and any use of such marks by The Source (Bell) Electronics Inc. is under license. Other trademarks and trade names are those of their respective owners.

WHAT'S IN THE BOX:

- Bluetooth® Selfie Stick
- Wrist strap
- USB charging cable
- Owner's Manual



OPERATION

When you use the stick for the first time or if unused for long periods of time, charge the battery. Rotate the holder to desired viewing angle and tighten the clamp. Place phone into the holder and extend the stick to desired length.

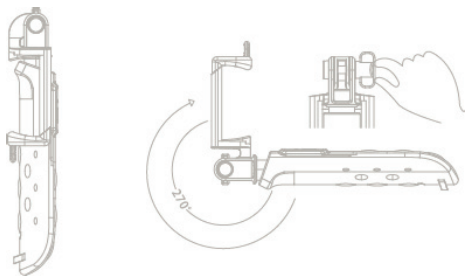

CHARGING

Connect one end of the included USB charging cable to the charging port on the stick. Then plug the other end of the USB charging cable into a suitable USB port on your computer or AC adapter to charge the battery. The red LED light will turn ON. The red LED light will turn OFF once the battery is fully charged.

ON/OFF

1. To turn the stick ON, press and hold the "shutter" button for 3 seconds. When the blue LED light blinks (inside the buttons), the stick is powered on.
2. To turn the stick OFF, press and hold the "shutter" button for 3 seconds. The indicator light will turn off.

PAIRING THE STICK

1. Make sure your smartphone is held within three metres of the stick.
 2. Power ON the stick.
 3. The stick automatically goes into pairing mode. The blue indicator light will flash for two minutes or until paired.
 4. Go to the Bluetooth® manager of your smartphone.
 5. Search for "Nexxtech 8063591" and connect to the stick.
- Note:** When the stick is powered ON it will automatically connect with the last paired smartphone.

TAKE PHOTOS

1. Open your camera application on your smartphone.
2. Position your smartphone to take a picture.
3. Press the "Shutter" button on the stick.

DEVICE SLEEP MODE:

To save battery power, the stick will go into sleep mode if there is no operation after 10 minutes. Press the shutter button once to wake up the stick and reconnect to your smartphone.

UNDERSTANDING THE LED STATUS LIGHTS

1. LED is OFF—powered OFF or in sleep mode
2. Blue LED ON—paired to Bluetooth® device
3. Blue LED blinks—Bluetooth® pairing
4. Red LED ON—charging, but if fully charged, the red LED will turn OFF

SPECIFICATIONS:

1. Battery Capacity: 55mAh
2. Working Current: ≤1.8mA
3. Standby Time: ≥500 hours
4. Autodyne Frequency: ≥500 times
5. Sleep Time: No operation for 10 minutes, the stick will enter into sleep mode
6. Working environment temperature: -10°C to 40°C
7. Working environment relative humidity: 10% to 90%
8. Operating System: iOS 6.0 or above and Android™ 4.0 or above

IMPORTANT SAFETY INSTRUCTIONS

- Read these instructions
- Keep these instructions for future reference
- Heed all warnings
- Follow all instructions
- Do not use this apparatus near water. The appliance should not be used near water or moisture, for example, in a wet basement or near a swimming pool
- Clean only with a dry cloth
- Do not block any ventilation openings. Do not install equipment in a confined space. Install in accordance with the manufacturer's instructions
- Do not install near any heat sources such as radiators, heat registers, stoves or other apparatus (including amplifiers) that produce heat
- Only use attachments/accessories specified by the manufacturer
- Refer all servicing to qualified personnel

For optimum performance, please read these instructions carefully and keep a copy for future reference. This Stick has a built-in Bluetooth® module that supports iOS 6.0 or above and Android™ 4.0 or above.

INDUSTRY CANADA NOTICE RSS247

This device complies with Industry Canada license-exempt RSS standard(s). Operation is subject to the following two conditions:

- (1) this device may not cause interference, and
- (2) this device must accept any interference, including interference that may cause undesired operation of the device.

This digital apparatus does not exceed the Class B limits for radio noise emissions from digital apparatus set out in the Radio Interference Regulations of Industry Canada.

IC Number: 255A-8063591

THE SOURCE - WARRANTY



The Source warrants that this product will be free from defects in materials and workmanship for a period of twelve (12) months from the date of purchase. Within this period, simply take the product and your proof of purchase to any The Source store or participating dealer and the product will be replaced (where available) without charge. Any product which has been subject to misuse or accidental damage is excluded from this warranty.

This warranty is only applicable to a product purchased through The Source company-owned stores or participating dealers in Canada where the warranty is included with the product. While this warranty does not confer any legal rights other than those set out above, you may have additional statutory rights which will vary under the laws of the various countries, states, provinces and other governmental entities in which The Source operates. This warranty is subject to all statutory rights you may have in Canada.

Imported by The Source
Barrie, Ontario, Canada, L4M 4W5
Manufactured in China
www.thesource.ca

© 2017 The Source
All rights reserved.



Please Recycle