

### OWNER'S MANUAL —

Before using the product, please read the instructions thoroughly and retain them for future reference.

8063400A

#### WARNING:

This item is not to be used with any Qi Wireless charging products as the metal plate can cause extreme heat that can cause burns and/or damage the device. Do not use with any hard-drive based devices.

#### PARTS INCLUDED

- Magnetic mount
- Medium metal plate
- Large metal plate
- Cleaning wipe

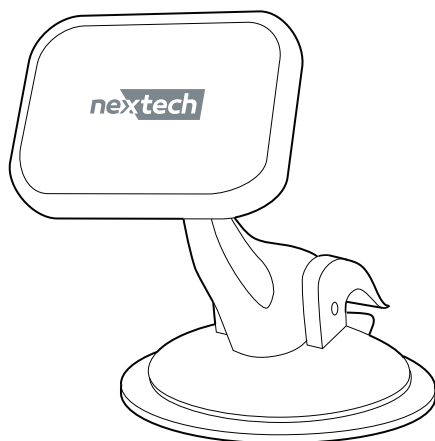

#### MOUNTING THE METAL PLATE

Prior to attaching the metal plate, clean mounting surface with the supplied cleaning wipe.

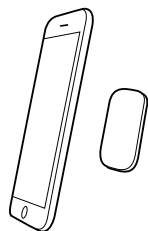

**Option 1:** Attach the adhesive side of the metal plate directly to the back of device.

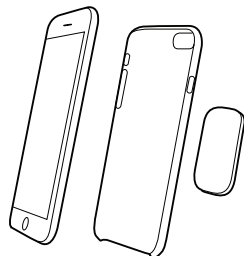

**Option 2:** Attach the adhesive side of the metal plate directly to the back of case.

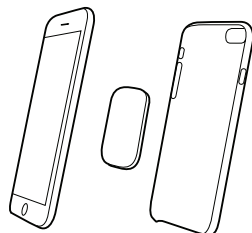

**Option 3:** Attach the adhesive side of the metal plate to interior of the case, between the device and the inside of case. Plate will adhere to the magnetic mount through the rear panel of the case.

**NOTE:** If choosing not to attach the metal plate to the device or case, leave the adhesive backing in place. Position the plate between the device and interior of case with the metal surface facing the case.

#### INSTALLATION

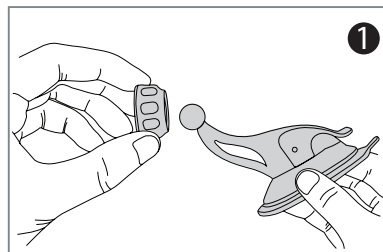

Place the screw cap (threads facing up) over mount's ball joint.

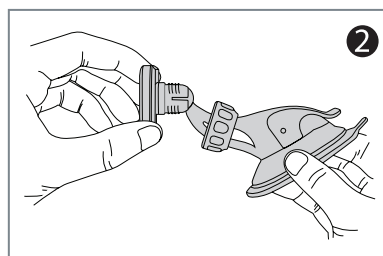

Snap the cradle onto the mount's ball joint, you will hear a "snap" when it is properly connected.

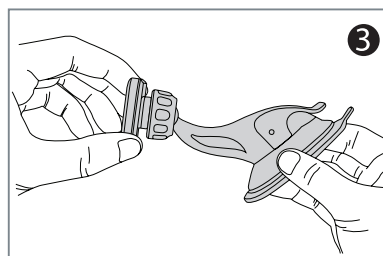

Tighten the screw cap to the cradle by turning it clockwise.

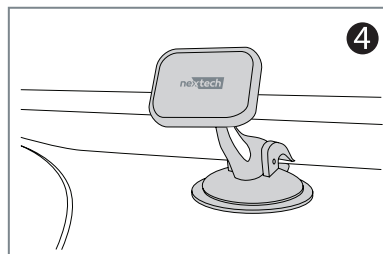

Find a location on your dashboard/windshield that is out of your direct line of sight. Clean the surface on your preferred dashboard/windshield location using the included cleaning wipe. Peel off the wrapping from the bottom of the base and position in place.

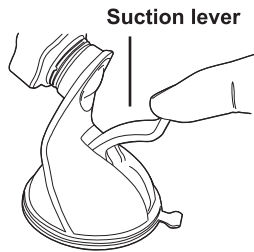

Press down on the base to apply pressure and lock the suction lever.

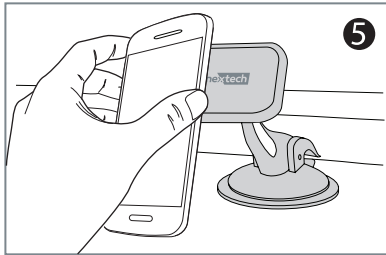

Attach device to magnetic mount.

Note:

- You may have to loosen the screw cap to adjust the cradle to your desired angle later
- Mount includes cable management hook

#### REMOVING THE METAL PLATE

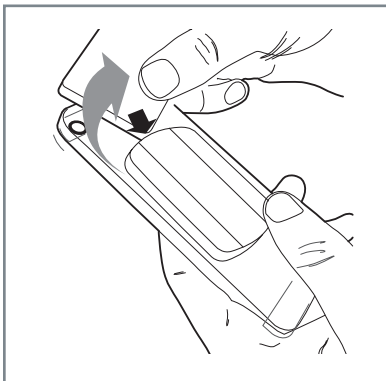

Use a thin plastic card to carefully lift the plate's magnetic surface from the mounting surface. Slowly lift up and remove the plate. Remove adhesive residue with a non-abrasive cleaner.

#### THE SOURCE - WARRANTY

The Source warrants that this product will be free from defects in materials and workmanship for a period of twelve (12) months from the date of purchase. Within this period, simply take the product and your proof of purchase to any The Source store or participating dealer and the product will be replaced (where available) without charge. Any product which has been subject to misuse or accidental damage is excluded from this warranty.

This warranty is only applicable to a product purchased through The Source company-owned stores or participating dealers in Canada where the warranty is included with the product. While this warranty does not confer any legal rights other than those set out above, you may have additional statutory rights which will vary under the laws of the various countries, states, provinces and other governmental entities in which The Source operates. This warranty is subject to all statutory rights you may have in Canada.

Imported by The Source  
Barrie, Ontario, Canada, L4M 4W5  
Manufactured in China

For product support please visit [www.thesource.ca](http://www.thesource.ca)

© 2017 The Source  
All rights reserved.



Please Recycle