

## 2.1 MULTIMEDIA PC SPEAKER SYSTEM

Thank you for purchasing the Nexxtech 2.1 Multimedia PC Speaker System. Please read this owner's manual carefully before proceeding.

### GETTING STARTED

#### WHAT'S IN THE BOX

- Subwoofer
- Satellite Speakers x 2
- User Manual

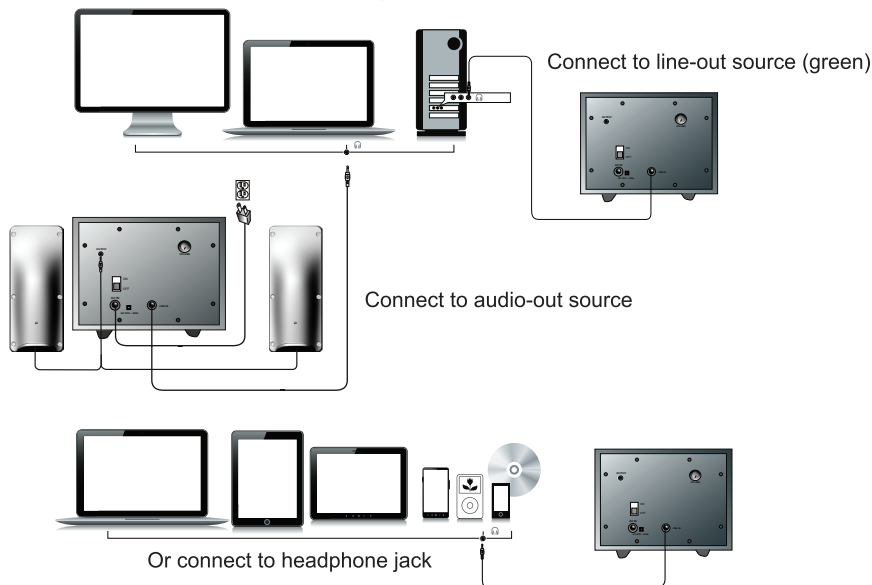
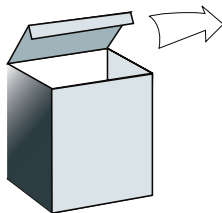

TO PREVENT FIRE OR SHOCK HAZARD, DO NOT USE THIS PLUG WITH AN EXTENSION CORD, RECEPTACLE OR OTHER OUTLET UNLESS THE BLADES CAN BE FULLY INSERTED TO PREVENT BLADE EXPOSURE. TO PREVENT FIRE OR SHOCK HAZARD, DO NOT EXPOSE THIS APPLIANCE TO RAIN OR MOISTURE.



The lightning flash with arrowhead symbol, within an equilateral triangle is intended to alert the user to the presence of uninsulated dangerous voltage within the product's enclosure that may be of sufficient magnitude to constitute a risk of electric shock to persons.

### CAUTION

**RISK OF ELECTRIC SHOCK  
DO NOT OPEN**

WARNING: TO REDUCE THE RISK OF ELECTRIC SHOCK DO NOT REMOVE COVER (OR BACK). NO USER SERVICEABLE PARTS INSIDE REFER SERVICING TO QUALIFIED SERVICE PERSONNEL.



The exclamation point within an equilateral triangle is intended to alert the user to the presence of important operating and maintenance (servicing) instructions in the literature accompanying the appliance.

## IMPORTANT SAFETY INSTRUCTIONS

- 1 Read these instructions.
- 2 Keep these instructions.
- 3 Heed all warnings.
- 4 Follow all instructions.
- 5 Do not use this apparatus near water.
- 6 Clean only with a dry cloth.
- 7 Do not block any ventilation openings. Install in accordance with the manufacturer's instructions.
- 8 Do not install near any heat sources, such as radiators, heat registers, stoves or other apparatus (including amplifiers) that produce heat.
- 9 Do not defeat the safety purpose of the polarized or grounding-type plug. A polarized plug has two blades with one wider than the other. A grounding plug has two blades and a third grounding prong. The wide blade or the third prong is provided for your safety. If the provided plug does not fit into your outlet, consult an electrician for replacement of the outlet.
- 10 Protect the power cord from being walked on or pinched, particularly at the plugs and at the point where they exit from the apparatus.
- 11 Only use attachments/accessories specified by the manufacturer.
- 12  Use only with the cart, stand, tripod, bracket, or table specified by the manufacturer, or sold with the apparatus. When a cart or rack is used, use caution when moving the cart/apparatus combination to avoid injury from tip-over.
- 13 Unplug the apparatus during lightning storms or when unused for long periods of time.
- 14 Refer all servicing to qualified personnel. Servicing is required when the apparatus has been damaged in any way, such as power supply cord or plug is damaged, liquid has been spilled or objects have fallen into the apparatus, the apparatus has been exposed to rain or moisture, does not operate normally or has been dropped.
- 15 A warning that batteries (battery or batteries or battery pack) should not be exposed to excessive heat such as sunshine, fire or the like.
- 16 Where the MAINS plug or an appliance coupler is used as the disconnect device, the disconnect device shall remain readily operable.

**WARNING:** TO PREVENT FIRE OR SHOCK HAZARD, DO NOT EXPOSE THIS APPLIANCE TO RAIN OR MOISTURE.

- ☐ This equipment is a Class II or double insulated electrical appliance, it has been designed in such a way that it does not require a safety connection to electrical earth.



This lightning flash with arrowhead symbol within an equilateral triangle is intended to alert the user to the presence of uninsulated "dangerous voltage" within the product's enclosure that may be of sufficient magnitude as to constitute a risk of electric shock to persons.



The exclamation point within an equilateral triangle is intended to alert the user to the presence of important operating and maintenance (servicing) instructions in the literature accompanying the appliance.

## INTRODUCTION

This speaker system is designed to deliver superior audio performance to computers, smartphones, MP3 players, DVD players, and other portable audio devices. The system offers high efficient drivers combined with low distortion, high-powered amplifier that provides deep bass with clarity and a greater dynamic audio range.

## CAUTION

- Do not plug the power supply in until all connections are made
- Use only the AC power cable supplied with these speakers
- Keep speakers away from sources of extreme heat, such as stereo amplifiers, space heaters, stoves and heat vents
- Use a dry cloth for cleaning. Do not wipe any part of the system with cleaning solvents, such as furniture wax, bleach, benzene, acetone or ammonia

## SPEAKER PREPARATION

**Subwoofer** - For optimum performance, place on the floor near a wall or corner. Adjust the distance from the corner or wall to control the quality of bass performance. Direct the open port toward the wall to increase bass punch.

**Satellite Speakers** - For best stereo separation, place on opposite sides of the listening device, computer, or TV screen (as far apart as possible is usually best). For example, if you are listening to the speakers using a laptop on a desk, place the left satellite speaker on the far left corner of the desk, and the right satellite speaker on the far right corner of the desk.

## SPEAKER CONNECTION

You can connect these speakers to a variety of devices, such as laptop, desktop, smartphone, iPod, MP3 player, CD player, DVD player, and other audio devices. Please read the following instructions along with the diagrams provided to identify which diagram most closely matches your connection source.

### DESKTOP COMPUTER

- Take the cable with the green plug and plug it into the green output/source jack in the back or front of the computer (also referred to as the sound/audio out jack)
- Connect the 3.5 mm plug to the "OUTPUT" jack on the back of the subwoofer
- Take the AC power adapter and plug it into a wall socket or power strip

### SMARTPHONE, IPOD, MP3 PLAYER, DVD PLAYER, OR CD PLAYER

- Take the cable with the green plug and plug it into the green output/source jack of the audio device
- Connect the 3.5 mm plug to the "OUTPUT" jack on the back of the subwoofer
- Take the AC power cord and plug it into a wall socket or power strip

## GAMING SYSTEM

- In order to connect these speakers to a game console, you will need a console gaming adapter, also known as a "Y adapter", which has dual RCA outputs. This item is sold separately
- Turn off the power to your gaming system
- Take the red and white dual-RCA connections on the Y adapter and plug them into the matching red and white RCA jacks on your gaming system
- Take the green stereo jack at the other end of the "Y" adapter and plug that into the subwoofer cable with the green plug
- Connect the 3.5 mm plug to the "OUTPUT" jack on the back of the subwoofer

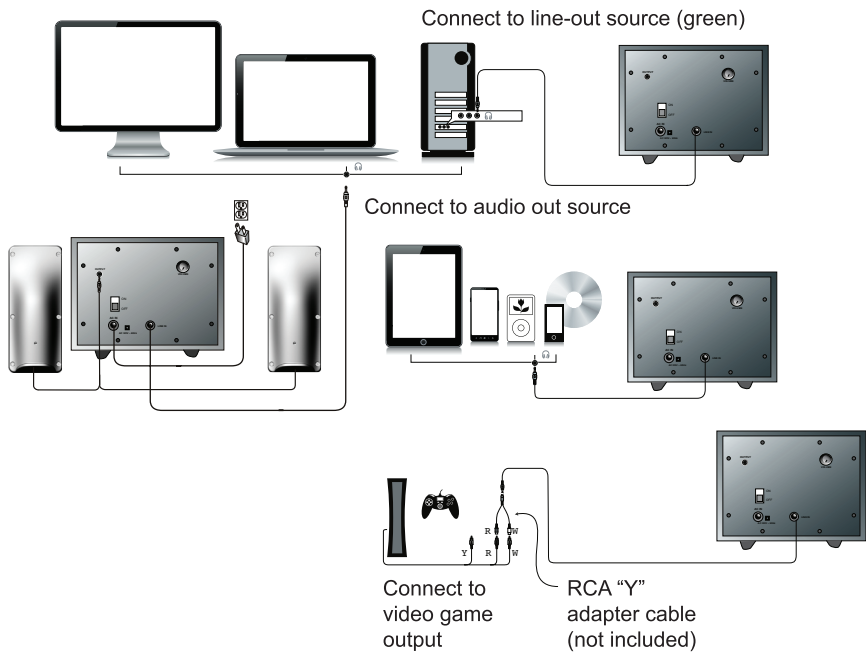

## CONTROLS AND FEATURES

- **Power** - The ON/OFF button is on the subwoofer. Press to turn the speaker on or off
- **Master Volume Control** - this control is on the subwoofer. Rotate clockwise to turn the volume up or counter-clockwise to turn the volume down

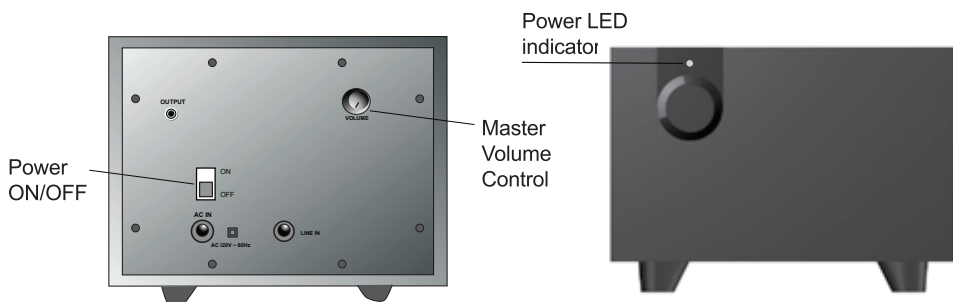

## TROUBLESHOOTING

**Symptom: Speaker system will not power on.**

**Solution:**

- Power button is not turned on. Press the power button back and forth and check for the blue LED indicator light to come on
- Verify the AC power adapter is plugged into the wall outlet
- Check if the wall outlet or power strip you are using is actually getting power, i.e. not a switched outlet

**Symptom: Speaker does not produce sound.**

Solution:

- Verify the speaker is getting power. Check above steps
- Make sure the volume is turned up to an audible listening level
- Verify that all cables are plugged into the correct jacks
- Many times users believe that the speakers are not working, when in fact they are having trouble with the sound source. The most common problem when connecting to a computer is that the connections are incorrect. Make sure you are connected to the audio output jack from your computer. Many times, this jack will be green. Also, make sure your media device or CD/DVD device is playing and the software volume settings are turned up and not muted
- If you still have problems, disconnect the speaker source cable from your computer and connect to a smartphone, iPod, or anything else with a 3.5mm headphone output. If your speakers work on this other source, you know they are functioning as normal and the issue likely lies with your computer or the connections

**Symptom: Sound is distorted.**

Solution:

- Turn the volume down by 25% or 50%. If this does not work, also check the audio software volume level and decrease it if necessary
- Adjust the computer's master volume control by balancing the volume until it's at 50%, then adjust the volume levels on the speakers

iPod, iPhone, iPad, and iPad mini are trademarks of Apple, Inc.

**CAN ICES-3(B).****THE SOURCE - WARRANTY**

The Source warrants that this product will be free from defects in materials and workmanship for a period of ninety (90) days from the date of purchase. Within this period, simply take the product and your proof of purchase to any The Source store or participating dealer and the product will be replaced (where available) without charge. Any product which has been subject to misuse or accidental damage is excluded from this warranty. This warranty is only applicable to a product purchased through The Source company-owned stores or participating dealers in Canada where the warranty is included with the product. While this warranty does not confer any legal rights other than those set out above, you may have additional statutory rights which will vary under the laws of the various countries, states, provinces and other governmental entities in which The Source operates. This warranty is subject to all statutory rights you may have in Canada.

Imported by:  
The Source,  
Barrie, Ontario, Canada, L4M 4W5  
Manufactured in China  
For product support please visit  
[www.thesource.ca](http://www.thesource.ca)



Please Recycle



© 2016 The Source. All rights reserved.