

- TV size range: 47-84"
- Maximum weight capacity:
60 kg/132 lbs
- Maximum mounting pattern:
800mm x 600mm (31.4" x 23.6")
- Distance to the wall: 26mm

47-84" Tilt Large TV Mount

INSTALLATION GUIDE

CAUTION

This product was designed to be installed on wood stud walls and solid concrete walls. Before installing make sure the supporting surface will support the combined load of the equipment and hardware. Never exceed the Maximum Load Capacity. This product is intended for indoor use only. Use of this product outdoors could lead to product failure or personal injury.

Hardware Kit:

ID	Qty	Description
I	1	Wall plate
2	2	Bracket
3	2	Plastic cover
A	4	M6×16mm bolt
B1	4	M8×16mm bolt
B2	4	M8×25mm bolt

ID	Qty	Description
C	4	M10×16mm bolt
D	10	M8 washer
E	4	M10 washer
F	4	Spacer
G	6	Long bolt
H	6	Wall anchor

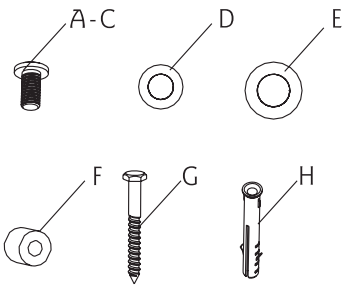
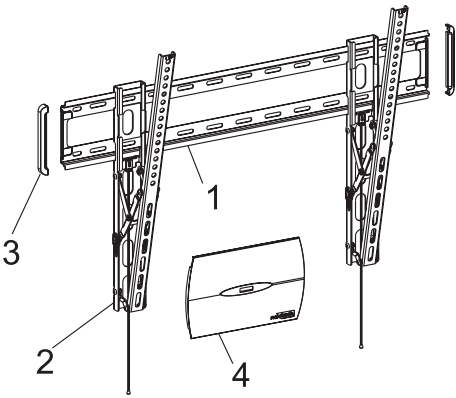

Part 1 -
Attaching plastic cover to wall plate

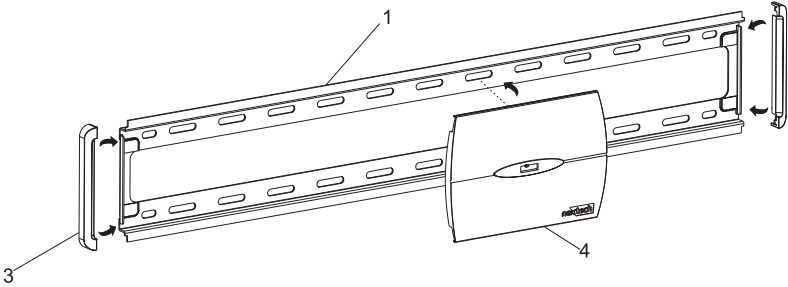

Part 2a - Wood Stud Mounting

With the wall plate (1) as a template, ensure it is level, and mark the six mounting holes along the centre lines of the wood stud. Drill six 5mm (3/16") diameter holes 80mm deep. Level the wall plate (1) and secure to the wall using the six long bolts (G) and six washers (E) supplied. Tighten the screws firmly. Do not overtighten.

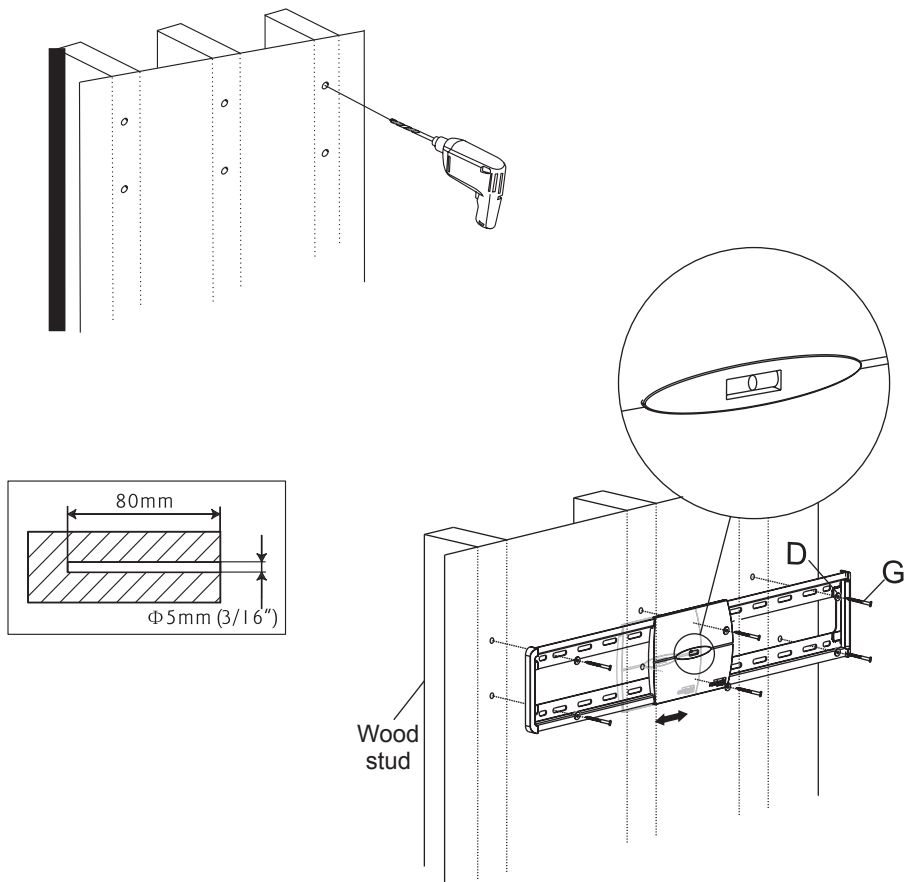

Part 2b - Concrete Wall Mounting

With the wall plate (1) as a template, ensure it is level, and mark the six mounting holes. Drill six 10mm (3/8") diameter holes 90mm deep. Insert the six anchors (H) into the holes and secure the wall plate using the six long bolts (G) and six washers (E) supplied. Tighten the screws firmly. Do not overtighten.

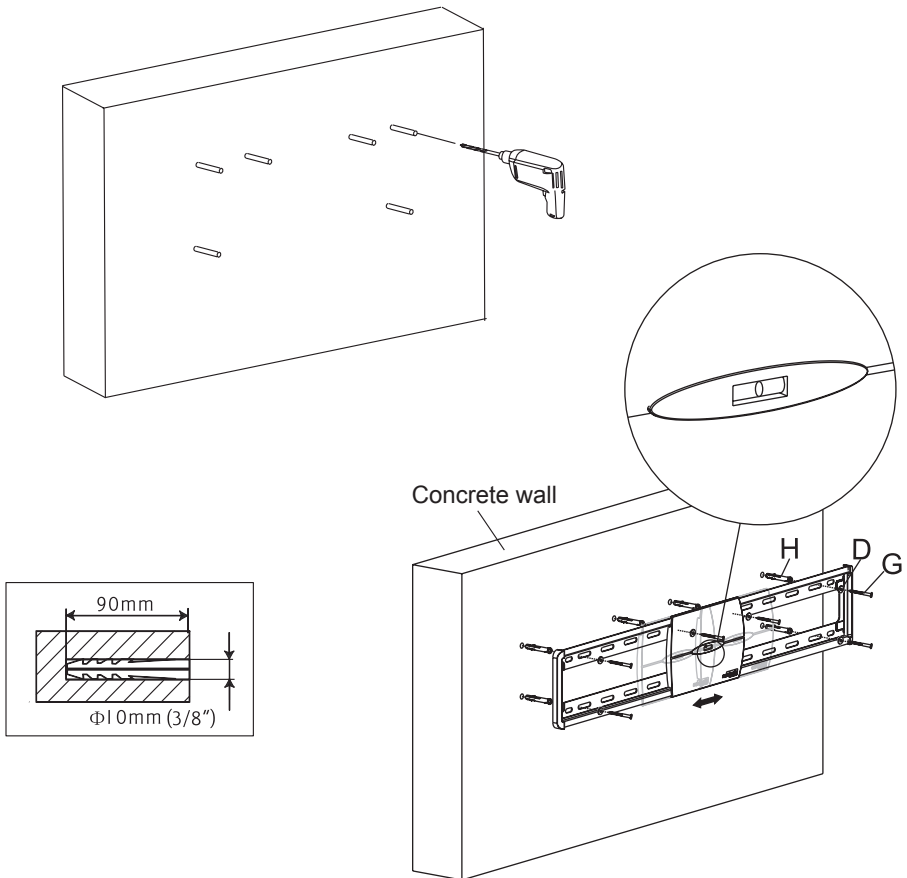

Part 3a - Attaching brackets to TV screens with flat back

Centre the brackets vertically on the back of the screen. Select the small (A, B1 or medium C) screws. Attach the brackets to the screen using the four selected screws and washers (D or E) at the top and bottom of each bracket. Tighten the screws firmly. Do not overtighten.

Washer (D or E)



D

Small hole for M6 and M8 screws



E

Medium hole for M10 screws

VESA Mounting Patterns:

800mm x 600mm, 800mm x 500mm,
800mm x 400mm, 800mm x 300mm,
700mm x 600mm, 700mm x 500mm,
700mm x 400mm, 700mm x 300mm,
600mm x 600mm, 600mm x 500mm,
600mm x 400mm, 600mm x 300mm,
600mm x 200mm, 500mm x 500mm,
500mm x 400mm, 500mm x 300mm,
500mm x 200mm, 400mm x 400mm,
400mm x 300mm, 400mm x 200mm,
300mm x 300mm, 300mm x 200mm,
200mm x 200mm, 200mm x 100mm

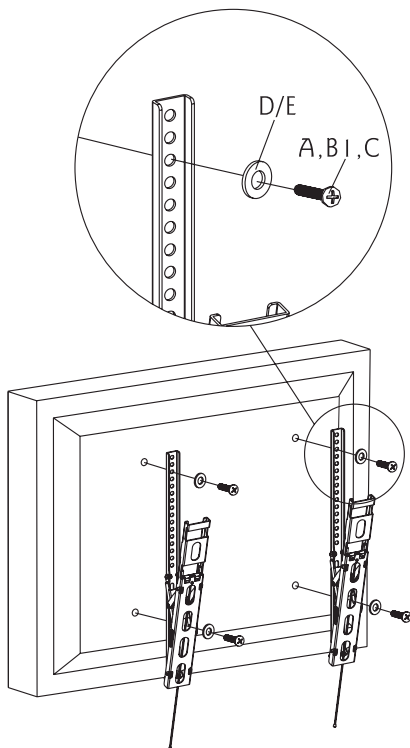

Part 3b - Attaching brackets to TV screens with recessed back

Centre the brackets vertically on the back of the screen. Select the large (B2) screws. Attach the brackets to the screen using the four selected screws, four washers (D), and four spacers (F) at the top and bottom of each bracket. Tighten the screws firmly. Do not overtighten.

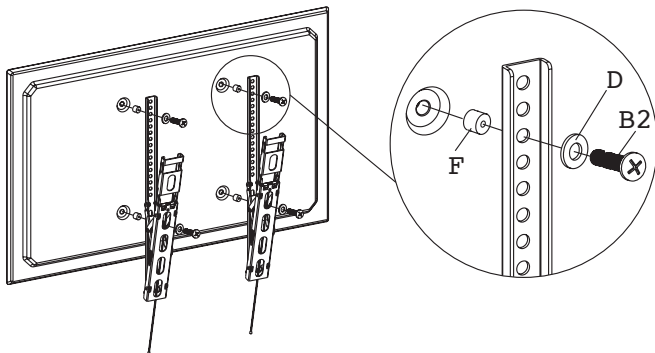

Part 4 - Mounting the flat panel screen

Hook the top of the brackets (2) onto the top ridge of the wall plate (1). Then gently swing the screen down.

NOTE: Always use an assistant or mechanical lifting equipment to safely lift and position heavy equipment.

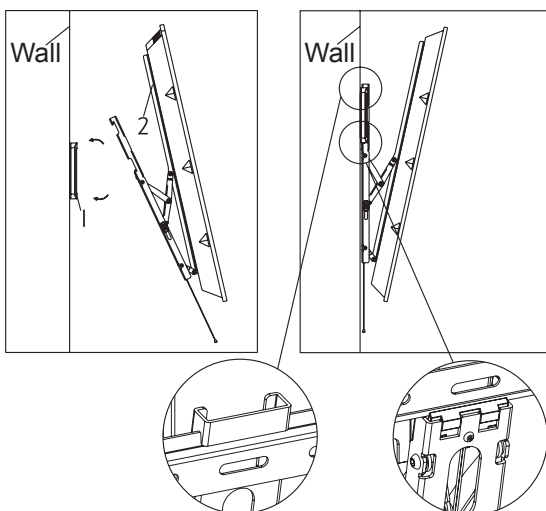

1. Press down on the brackets once it is installed on the wall plate, it will lock in place.

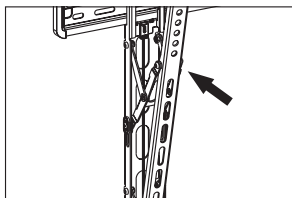

2. Gently swing the TV to install the cables after you have unlocked the brackets from the wall plate.

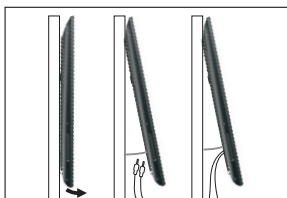

3. When you need to take the TV down, first pull down on the two strings together to unlock the brackets from the wall plate.

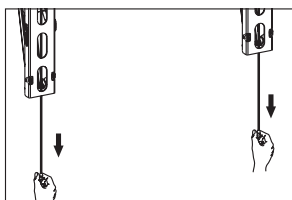

4. The locking strings can be cut if they are too long and hang below the display.

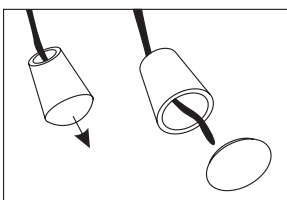

Warning

This product contains small items that could be a choking hazard if swallowed. Keep these items away from young children!

1. Make sure these instructions are read and completely understood before attempting installation. If you are unsure of any part of this installation, contact a professional installer for assistance.

2. The wall or mounting surface must be capable of supporting the combined weight of the mount and the display; otherwise the structure must be reinforced.

3. Safety gear and proper tools must be used. A minimum of two people are required for this installation. Failure to use safety gear can result in property damage, serious injury or death.

THE SOURCE – WARRANTY



The Source warrants that this product will be free from defects in materials and workmanship for a period of (1) year from the date of purchase. Within this period, simply take the product and your proof of purchase to any The Source store or participating dealer and the product will be replaced (where available) without charge. Any product which has been subject to misuse or accidental damage is excluded from this warranty.

This warranty is only applicable to a product purchased through The Source company-owned stores or participating dealers in Canada where the warranty is included with the product. While this warranty does not confer any legal rights other than those set out above, you may have additional statutory rights which will vary under the laws of the various countries, states, provinces and other governmental entities in which The Source operates. This warranty is subject to all statutory rights you may have in Canada.

Imported by:
The Source,
Barrie, Ontario, Canada, L4M 4W5

Manufactured in China

For product support please visit
www.thesource.ca

© 2016 The Source
All rights reserved.

